

Mudmap for TBD parking at Queanbeyan Park, Sunday 2nd December.

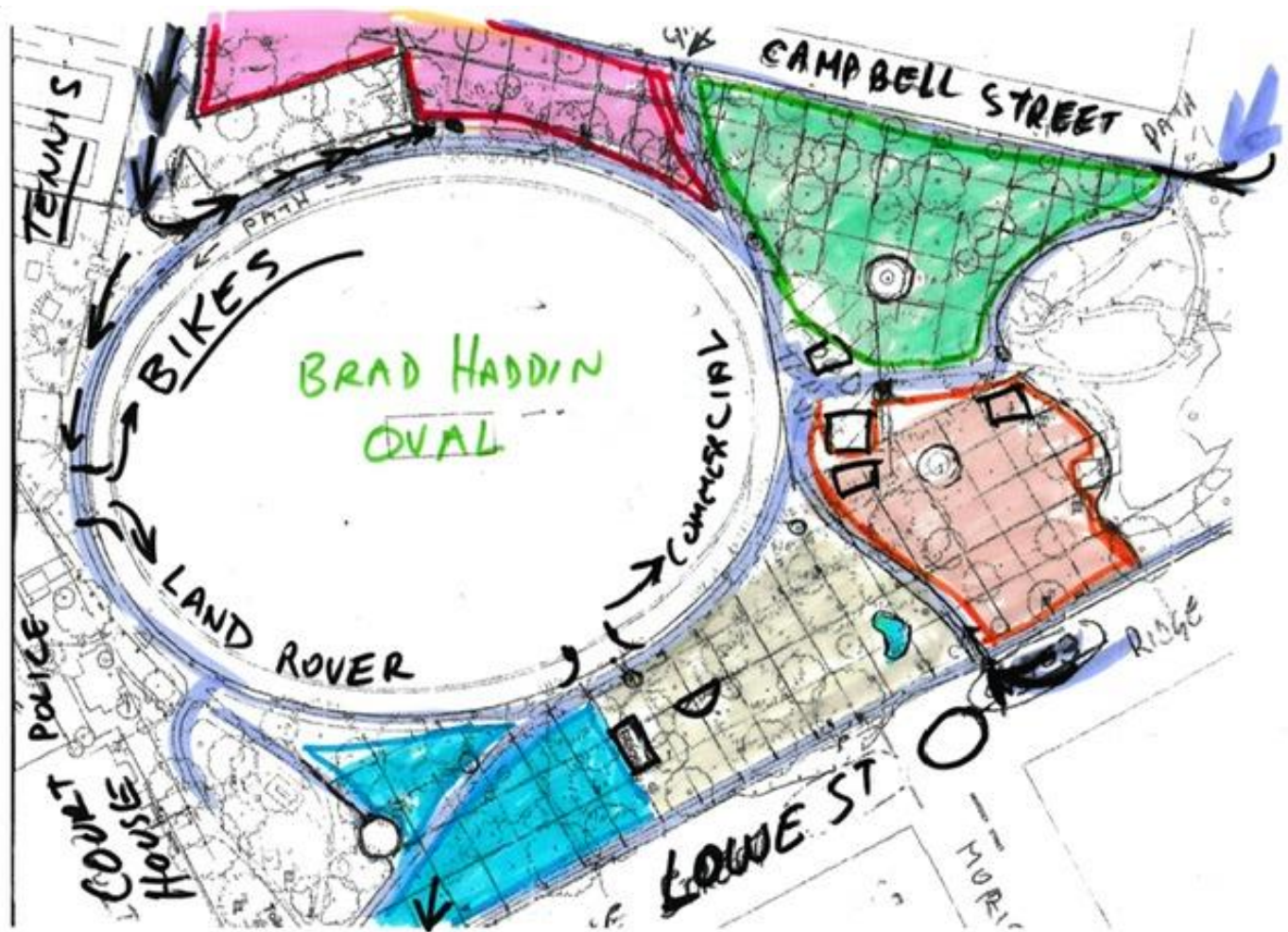

NB: Map orientation has North to the right! (The map's left edge is Kings Hwy)

Key:

Campbell Street entrances:

North end:	Green Sector:	Triumph, Riley, Jensen
Centre:	Pink sector:	MG, Aston Martin, Healey
South end:	Oval:	Motorcycles & Land Rover

Lowe Street entrance (adjacent to roundabout):

Orange Sector:	STHARC, Classic Canberra, Rolls Royce, Bentley & Yellow Sector:	Mini, Morris, Austin
----------------	---	----------------------

Lowe Street entrance (adjacent to Court House)

Blue Sector:	Jaguar
--------------	--------

There will be marshals from STHARC & ACT Triumph clubs to guide & park the cars as tidy as possible, some areas (Blue and Yellow) have recently been reseeded, drivers should minimise damage to the turf.